

SONDA S1

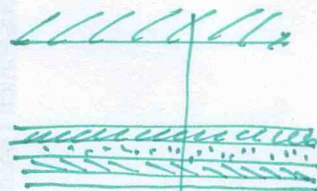

- ŽB DESKA
- VZDUCH. MEZERA 150
- DŘEV. ZÁKLAD 15
- PALACH + OMÍTKA
- SDK S DŘEV. ROŠTEM /SDK 15/

SONDA S2

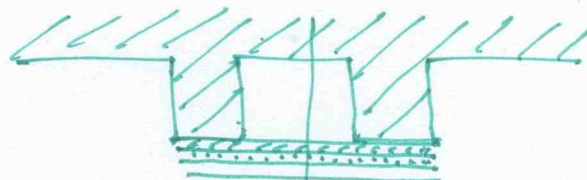

760
270 270

- ŽB DESKA
- VZDUCH. MEZERA 600
- ZÁKLAD DŘEV. 20
- PALACH + OMÍTKA
- SDK 12

SONDA S3

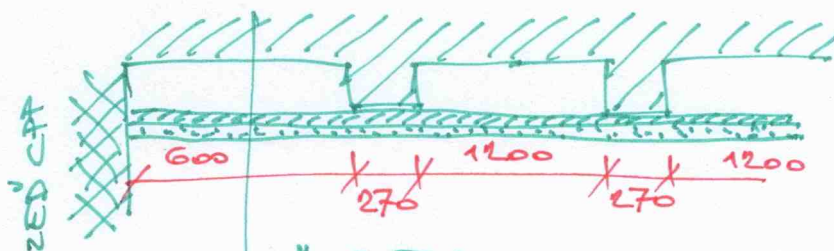

ZED' CFA

600 1200 1200
270 270

- ŽB DESKA
- VZDUCH. MEZERA 200
- DŘEV. ZÁKLAD 15
- PALACH + OMÍTKA

SONDA S4

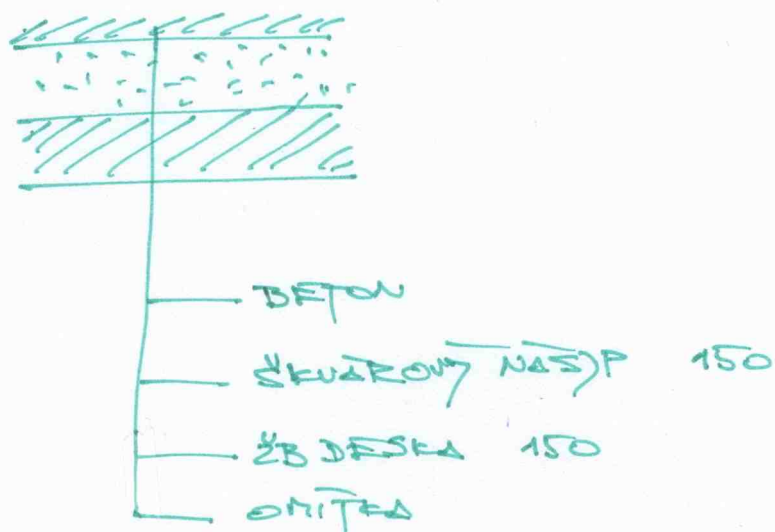

SONDA S5

PRŮČNĚ PRŮVLAK) - viz PŘÍLOHA PŮDORYSU

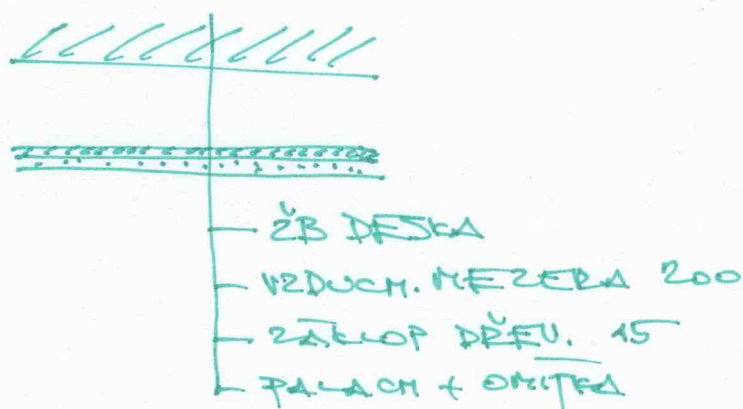

SONDA S6

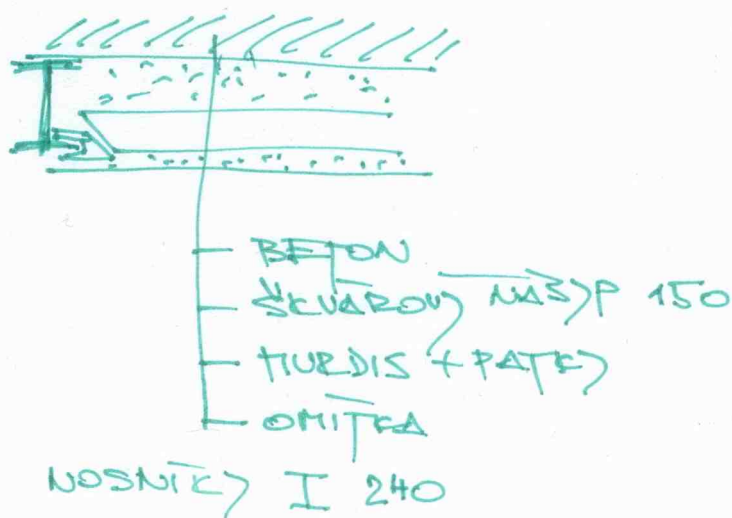

SONDA S 7

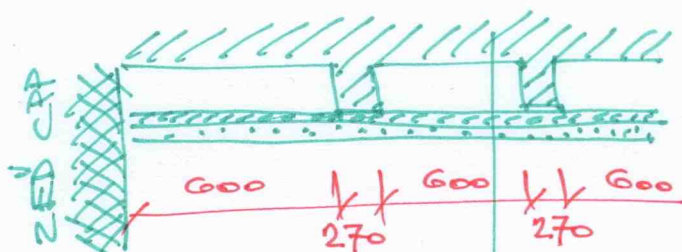

- ZB DFSCA
- OZDUCH. MEZERA 200
- DEK. ZDELOP 20
- PALACH + ORITEA

